



Series  
TVA

# All Fluoropolymer Flow meters

75 mm and 125 mm, 10:1 Turn down,  $\pm 5\%$  FS Accuracy



Model	A	B	C	D	E	F	G
TVA11XX	4.97 [126]	0.56 [14]	1.06 [27]	3.35 [85]	1.25 [32]	6.16 [156]	1/4
TVA13XX	4.97 [126]	0.56 [14]	1.25 [32]	4.65 [118]	1.50 [38]	6.16 [156]	3/8
TVA22XX	8.72 [221]	0.88 [22]	1.75 [44]	4.57 [116]	2.00 [51]	10.4 [264]	1/2
TVA24XX	8.47 [215]	1.00 [25]	1.75 [44]	5.95 [151]	2.25 [57]	10.4 [264]	3/4

**Panel Mounting:** Drill two holes: 3/4" dia. at 4.97" apart for 1/4" NPT models, 7/8" dia. at 4.97" apart for 3/8" NPT models, 1" dia. at 8.72" apart for 1/2" NPT models, and 1-1/4" dia. at 8.47" apart for 3/4" NPT models (center-to-center).

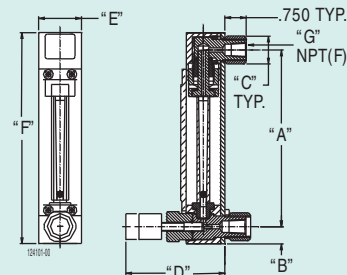

**Series TVA All Fluoropolymer Flowmeters** offer solutions for measuring flow rates of highly corrosive or ultra-pure liquids. Flowmeters are designed with 0 to 10 scale graduations denoting a discrete flow rate.

Model		Low Range		
Valve	No Valve	Length	Connections	Flow Rate (H <sub>2</sub> O) gph (ml/min)
TVA1113	TVA1103	75 mm	1/4" female NPT	6.34 (400)
TVA1115	TVA1105	75 mm	1/4" female NPT	15.9 (1000)
TVA1317	TVA1307	75 mm	3/8" female NPT	39.6 (2500)
TVA1319	TVA1309	75 mm	3/8" female NPT	79.2 (5000)
Model		High Range		
Valve	No Valve	Length	Connections	Flow Rate (H <sub>2</sub> O) gph (l/min)
TVA22110	TVA22010	125 mm	1/2" female NPT	3.43 (13)
TVA24112	TVA24012	125 mm	3/4" female NPT	7.93 (30)
TVA24114	TVA24014	125 mm	3/4" female NPT	11.9 (45)

## SPECIFICATIONS

**Service:** Compatible liquids.

**Wetted Materials:**

- Flowtube: PFA;
- Float and End Fittings: PTFE;
- Guide Rods: PCTFE.

**Temperature Limit:** 250°F (121°C).

**Pressure Limit:** 100 psig (6.9 bar).

**Accuracy:**  $\pm 5\%$  FS @ 70°F (21.1°C) and 14.7 psia (1 atm absolute).

**Repeatability:**  $\pm 0.25\%$ .

**Leak Integrity:**  $1 \times 10^{-7}$  sccs of Helium.

**Scales:** 0 to 10 markings, 75 mm or 125 mm lengths.

**Turn-down Ratio:** 10:1.

**Mounting:** Vertical.