

BT/BG 175 Bronze Butterfly Valve

UL Listed / FM Approved

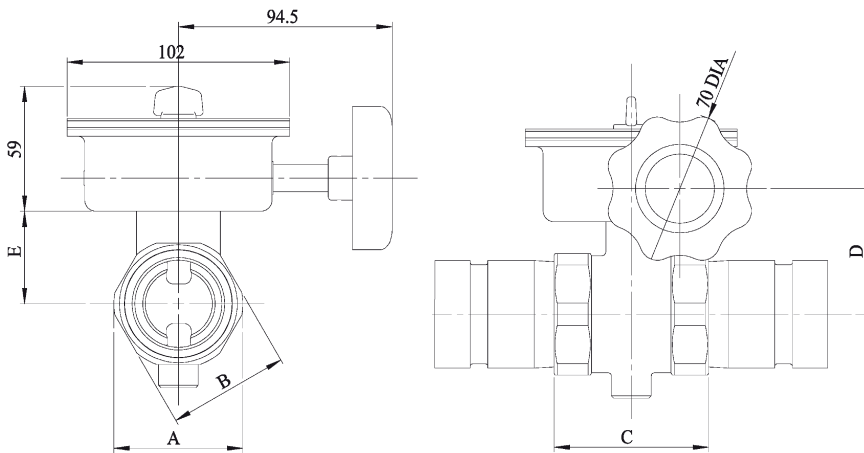

Description

Size range 1 1/4", 1 1/2" NPT threaded with optional grooved adaptors. 2" grooved only.

Pressure & Temperature

Max Working Pressure: 12 Bar
 Max Test Pressure: 25 Bar
 Max Working Temperature: 120°C

Factory installed UL Listed Double Tamper Switch for Indoor and Outdoor Use

Dimensions

| Size NPT/Grooved | Pipe O/D mm | A mm | B mm | C mm | D mm | E mm | Overall length with grooved adaptors mm | Weight Kg |
|------------------|-------------|------|------|------|------|------|---|-----------|
| 32mm | 42.2 | 54 | 49 | 67 | 56 | 41.0 | 140 | 1.7 |
| 40 mm | 48.3 | 60 | 70 | 73 | 59 | 61.3 | 140 | 1.9 |
| 50 mm | 60.3 | N/A | N/A | 114 | 64 | 49.0 | N/A | 2.3 |

Material Specification

Item: ASTM
 Body: ASTM B-505
 Disc: ASTM B-584 EPDM Encapsulated
 Upper Stem: ASTM A-564 Type XM 12
 Lower Stem: ASTM A-564 Type XM 12
 Gear Housing Cove: ASTM A-619
 Hand Wheel: ASTM A-619
 Flag Indicator: ASTM B-16
 York Mechanism: ASTM A-283
 Stem Bushing: ASTM B-16
 Conduit Connector: ASTM A-307
 O-Rings (All): EPDM Grade "E"
 Cover Gasket: NBR

Rapidrop Global