



Rapidrop Lumi-Plugin Emergency Sprinkler Lighting

Product Description

Typically fire suppression systems, fire detection and emergency lights all compete with interior lighting for the same space within the ceiling layout. Now they don't have to.

The compact and simplistic design of Lumi-Plugin, allows it to seamlessly blend into its surroundings combining and or enabling services without compromising the property's interior.

Lumi-Plugin's multi-functional design can reduce initial installation costs due to combined systems rather than separate installations, reducing the quantity and size of openings required in the ceiling structure. Additional lifetime savings can be achieved due to low voltage LEDs and PIR sensor plugins.

The unique patented design where the luminaire fully surrounds the sprinkler head ensures that the future operation of the sprinkler head cannot be compromised from the application of paint or sealant accidentally being applied.

IP65 Rating

With an IP65 rating, Lumi-Plugin is both dust proof and water resistant to ensure the longevity of the product. Sprinkler heads should not be installed where they may be subjected to a corrosive environment including chlorine ion and chloride. IP65 rating applies to light only.

Fire Rated 30/60/90

Lumi Plugin exceeds the requirements of BSEN 1365-2: 2014, fire resistance tests for loadbearing elements, floors and roofs. These tests were conducted at the Building Research Establishment (BRE) based in Watford, United Kingdom.

Emergency Lighting

The optional integrated emergency lighting power supply facility provides up to 3 hours normal light illumination, providing the time needed to exit or get to a place of safety.

Cool White or Warm White Light

Suitable for both domestic and commercial properties with 2700K or 4000K variants available.

Test/Approvals

- Loaded floor test to EN 1365-2: 2014
- CE Marked

LPCB Commercial Installations

Commercial installations to LPS 1048 can be achieved in conjunction with RD101, RD102 and RD107

Residential Installations

Residential Installations to BS 9251: 2014 can be achieved in conjunction with RD201 and RD205 sprinkler heads.



Specification

Description	Materials
IP Rating	IP65
Material	Mixed (Metal and Plastic)
Input Voltage to Luminaire	16V
Input Voltage to Driver	220V-240V
Power Output	9.5W
Colour Temp	4000K + 2700K
Light Colour	Cool White / Warm White
Dimmable	Yes
Fire Rating	30/60/90
Luminaires per pack	1
Product Diameter	120mm
Product Depth	70mm
Hole Cutout Size	92mm
Hours	50,000
Lumens	700L
Beam Angle	60°
Available Colours	White or Chrome as standard RAL Colors to order

Rapidrop Lumi-Plugin Emergency Sprinkler Lighting

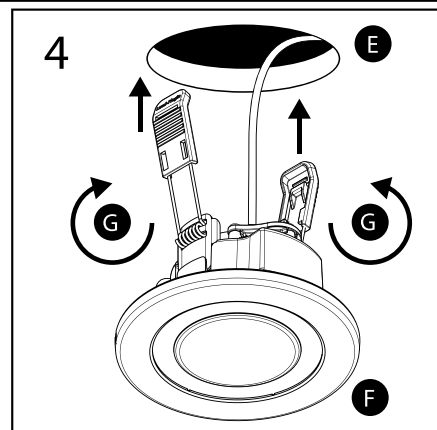
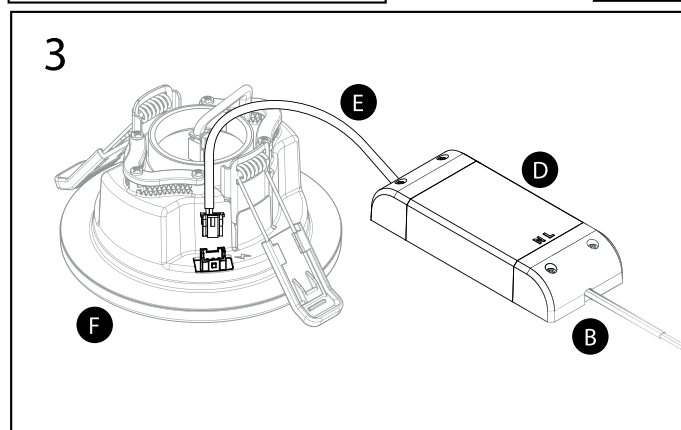
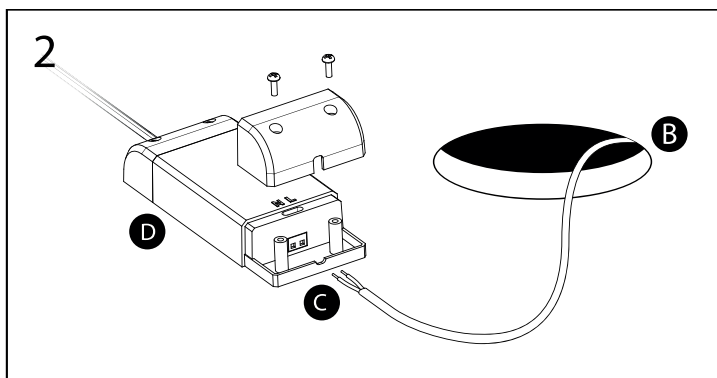
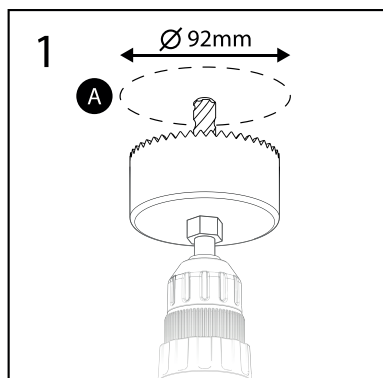

A Ceiling surface B Mains supply C Live / Neutral cable D LED Driver E LED Driver output cable F Lumi-Plugin Downlight G Spring clips

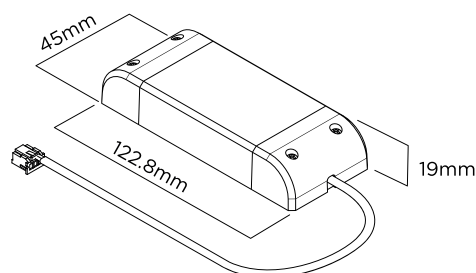
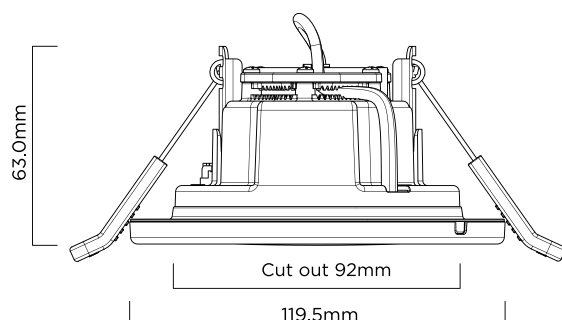

PACK CONTENTS

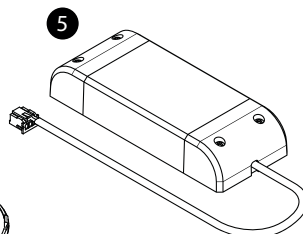
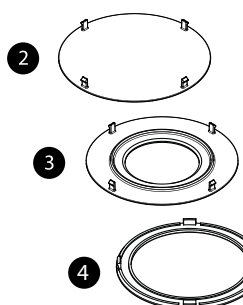
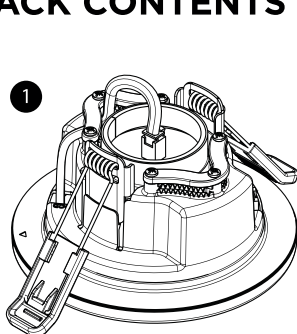

- 1 Lumi-Plugin LED Downlight including spring clips.
- 2 1 x Standard cap
- 3 1 x Semi-Concealed cap
- 4 1 x Concealed cap,
- 5 LED Driver, complete with mini connector

Rapidrop Lumi-Plugin Emergency Sprinkler Lighting

Installation Instructions When Combined with Rapidrop Sprinkler Heads

The original classifications for sprinkler response time index and water spray distribution remain unchanged as long as the installation instructions below are adhered too.

1. Electrical power connection to the supplied transformer must be completed by a competent person, ie Part P compliant for domestic applications, NICEIC compliant for industrial applications. Isolate power supply.
2. The Rapidrop sprinkler heads must be installed in accordance with the relevant Rapidrop technical data sheets. The vertical installed depth above / below the ceiling level must be within the maximum/minimum limits given on the technical data sheet. Note: an allowance of 6mm is to be taken into consideration as the LP120 light unit will sit 6mm below the ceiling level. The latest issue data sheets are available from www.rapidrop.com.
3. Isolate water supply after completion of sprinkler system verification test in accordance with applicable system design and installation codes.
4. Prepare a 92mm diameter round hole in the ceiling board / tile that when installed will align with the centre line of the sprinkler head drop pipe. The use of Rapidrop flexible sprinkler connection drops will afford both horizontal and vertical adjustment to ensure correct positioning.**
5. Mount ceiling board / tile with transformer power lead protruding through the 92mm diameter hole.

6. When using CPVC sprinkler pipe drops, remove the top intumescent seal from the LP120 light unit.

7. Remove centre cap from the LP120 light unit. When installing in conjunction with Rapidrop concealed sprinkler heads, replace with the 48mm adaptor ring supplied.

8. Connect transformer power lead to the LP120 light unit.

9. Compress spring arms and pass LP120 light unit through the 92mm hole.

10. Remove sprinkler cover cap.

11. Mount Rapidrop concealed sprinkler head cover plate, or insert 30mm adaptor ring when installing in conjunction with Rapidrop flush pendent sprinkler heads.

12. Re instate both water and electrical power supply.

** When installed with Rapidrop flexible sprinkler connection drops, the LP120 light unit can be mounted in the ceiling board / tile and the sprinkler head passed through the centre of the light unit from above.

The LP120 LED light unit is designed so that if required, sprinkler heads can be dismantled and remounted without the need to remove the light unit using Rapidrop socket RD101/102/107. In the event that the LP120 light unit needs to be replaced, it can be withdrawn over the sprinkler head without the need to remove the sprinkler head itself, only the sprinkler head concealed cover plate.

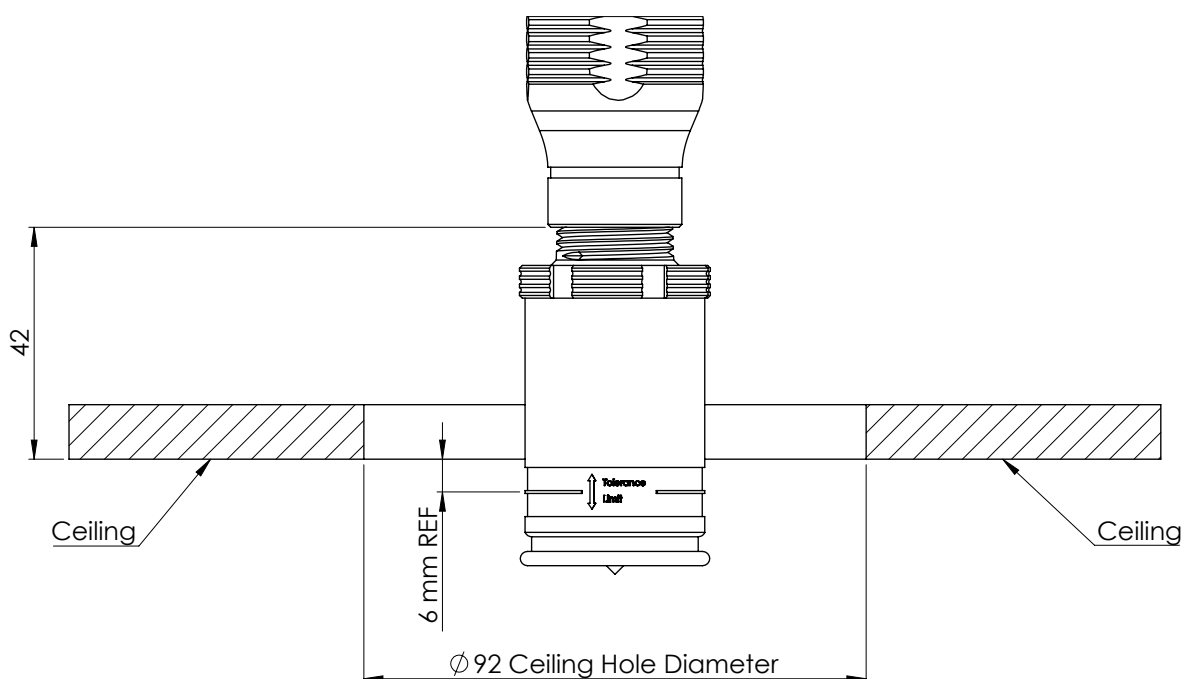

Rapidrop Lumi-Plugin Emergency Sprinkler Lighting

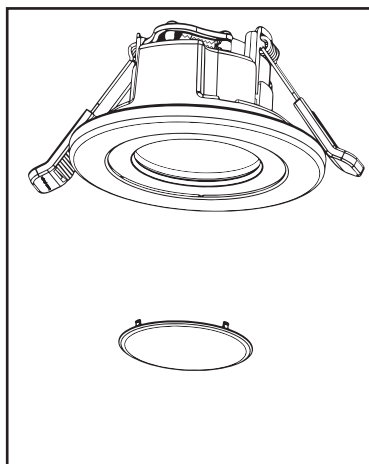

Lumi Light

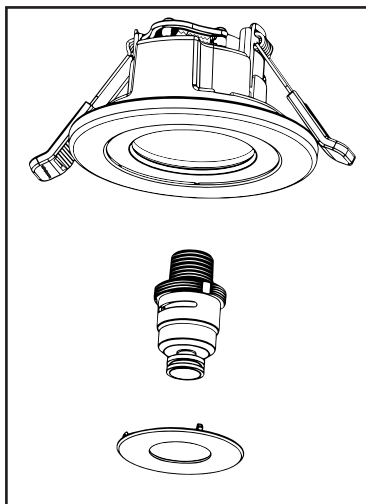

Lumi Light with Flush Pendent sprinkler

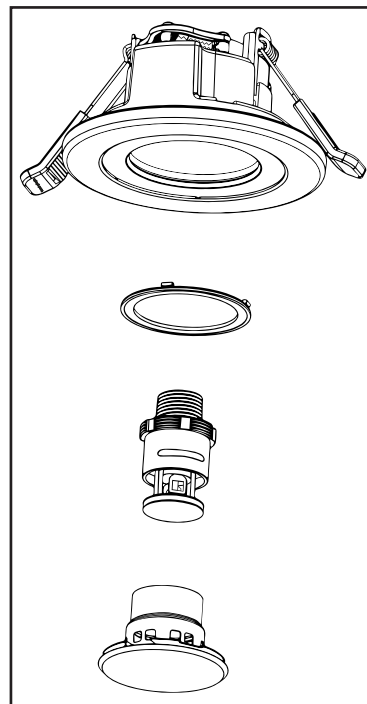

Lumi Light with Concealed sprinkler

Important Information

- The original classification of sprinkler response time index and water spray distribution remain unchanged as long as the installation instructions on www.rapidrop.com website are adhered to.
- The luminaire is designed for indoor use only.
- The luminaire must be installed in accordance with local wiring regulations if in doubt seek advice from a qualified electrician.
- The luminaire is dimmable, a trailing-edge dimmer must be used.
- The luminaire is fire rated 30/60/90 minutes under EN1365-2:2014 fire test.
- The luminaire is designed so that if required, Rapidrop flush pendent and concealed sprinkler heads can be dismantled and replaced without the need to remove the luminaire.
- In the event that the luminaire needs to be replaced, it can be withdrawn over the sprinkler head without the need to remove the sprinkler head itself. Rapidrop concealed type heads will require only the cover plate to be removed prior to the luminaire.
- Before installing or completing maintenance work on the luminaire, make sure the mains power is switched off.
- The light source of this luminaire is not replaceable; when the light source reaches its end of life the whole luminaire must be replaced.
- The luminaire is IP65 rated (Zone 1) so is suitable to be installed in wet areas.
- The driver provided is the only driver that can be used with this luminaire.

Sprinkler Head Selection:

LPCB Comercial: RD101 / 102 Flush Pendent
RD107 Concealed

Residential: RD201 Flush Pendent
RD205 Concealed

Guarantee

- This product is guaranteed for a period of 5 years or 50,000 hours depending which comes first.
- The guaranteed period is invalid if the luminaire has been tampered with, removal of the luminaire labels; manufacturing label, rating label and serial label or the luminaire has not been installed in accordance with local wiring regulations.
- If the product does fail within the guaranteed period Sleep Safe Systems Limited T/A Lumi-Plugin will replace the luminaire free of charge but have no responsibility for the installation costs.
- Lumi-Plugin reserves the right to change the product specification without notice.
- Lumi-Plugin are not responsible for any liability relating to the sprinkler installation, operation or maintenance.