

SENTRY MICROMAG MAGNETIC FILTER

Sentry SmartSkin

MAGNETIC SEPARATORS

Ensure your wash stations functionality and efficiency with Sentry SmartSkin MicroMag Magnetic Filters.

MicroMag's compact yet powerful construction ensures your equipment remains efficient by removing free floating contaminants. The magnetic filter's process allows fluid to enter through an inlet port and up to a magnetic core where particles are contained.

Sentry's magnetic separator reduces the need for maintenance by maintaining continuous flow, controlling core build up. This patented design comes in a variety of sizes and PSI limits to meet your unique needs.

BENEFITS

- Designed for easy installation and minimal maintenance
- Has a high collection capacity relative to its size
- Meets operational pressures 175 to 1160 PSI

FEATURES

- Aluminum or stainless-steel design depending on the model
- Capacity ranges from 2.2 to 8.8 pounds
- Heights vary, but diameter is no larger than 5.5"



MM



MM/HP/80



Sample. Monitor. Measure.



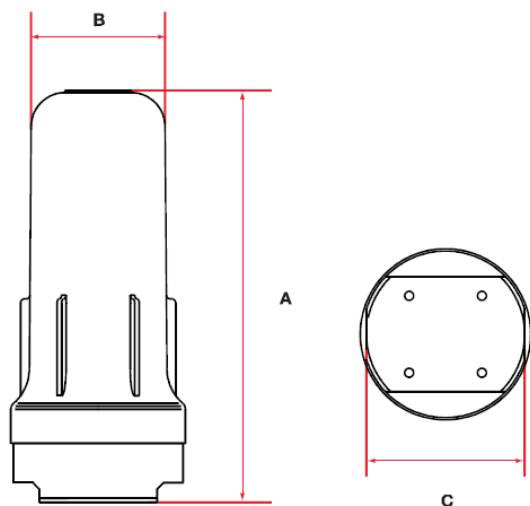

Product number	Flow rate Gallons	Contamination capacity lbs	Max. operating pressure psi	Connection NPT "	Temperature range F	Construction	Dimensions inches		
							A	B	C
MM5 /1.0	18	2.2	174	1	41-122	SAN housing, aluminum lid	7.5	3.7	4.1
MM10 /1.0	26	4.4	174	1	41-122		12.4	4.0	4.9
MM20 /1.5	40	8.8	174	1½	41-122		23.9	4.0	5.3
MM5/HP/50 NPT	18	2.2	725	1	32 – 284	Full aluminum construction	9.7	4.6	4.9
MM10/HP/50 NPT	26	4.4	725	1	32 – 284		14.3	4.6	4.9
MM20/HP/50 NPT	40	8.8	725	1½	32 – 284		24.6	4.6	4.9
MM5/HP/80 NPT	18	2.2	1160	1	32 – 284	Full stainless steel construction	9.7	4.6	4.9
MM10/HP/80 NPT	26	4.4	1160	1	32 – 284		14.3	4.6	4.9
MM20/HP/80 NPT	40	8.8	1160	1½	32 – 284		24.6	4.6	4.9

SPECIFICATIONS

Input Power	1 in NPT
Materials of Construction	Stainless Steel (other materials available upon request)
Maximum Process Pressure	1160 PSI at 284°F (80 barg at 140°C)
Flow Rate	40 GPM



SENTRY MICROMAG MAGNETIC ROD FILTERS

Sentry SmartSkim

MAGNETIC FILTERS

Enhance the quality of your fluid filtration and systems parts with high-powered magnetic rod filters and micro mag grids.

Sentry's adaptable SmartSkim MagGrid Rod Filters are designed to fit to your application and add to your tool and fluid life. By implementing the MagGrid product, your operations will enhance the fluid and parts quality and protect your pumps in machine tools, washers, paint lines, and other industrial systems.

The stainless-steel cage allows the magnetic post on the magnetic rod filter to remain centered for high-powered fluid filtration. Available in a variety of sizes, magnetic rod filters are an efficient way to remove small ferrous particles.

BENEFITS

- Extend fluid and tool quality
- Protect your high value pumps

FEATURES

- Handles heat up to 176°F (80°C)
- Maximize longevity with 304 SS
- Includes a cage on your magnetic rods to keep the post centered
- Variety of sizes available – 8", 12", 16", & 24"



Sample. Monitor. Measure.



SPECIFICATIONS

Wetted Materials	304 SS
Materials of Construction	304 SS
Process Pressure	30 psig (2 barg)
Flow Rate	50 GPM
Process Temperature	Up to 250°F (121°C)



Rometec s.r.l.

Via Alessandro Minuziano, 87-89 , 00128 Roma

Tel. 065061635 – Fax 065061542

Sito web: www.rometec.it – email: info@rometec.it

P. IVA 04120621000 - CCIAA RM 736916

Reg. Soc. Tribunale RM 9229/91 - Cap. soc. 46'482,00 €



sentry-equip.com

966 Blue Ribbon Circle North, Oconomowoc, WI 53066 U.S.A. | +1-262-567-7256 | sales@sentry-equip.com

© 2015 Sentry Equipment Corp. All rights reserved. All product and company names are property of their respective owners. It is solely the responsibility of end users, through their own testing and analysis, to select products and materials suitable for their specific application requirements, ensure they are properly installed, safely applied and properly maintained, and to limit their use to their intended purpose. Improper selection, installation or use may result in personal injury or property damage.



COMPANY WITH
QUALITY SYSTEM