



# SENTRY ISOPURE SAMPLER

## Aseptic Samplers

### MANUAL SAMPLING

The Sentry® IsoPure sampler allows easy and safe sampling of liquids from closed systems such as vessels and pipelines. The aseptic, compact design provides a permanent valve integration into aseptic and hygienic production lines, eliminating the need for costly consumables. The IsoPure sampler has a dead space free design that can be easily cleaned and sterilized via clean-in-place (CIP) or sterilize-in-place (SIP). The PTFE (e.g., Teflon®) bellows guarantee hermetic sealing against the environment to prevent process contamination.

### MODELS

IsoPure

### BENEFITS

Process inspections have become an indispensable part of sterile and hygienic process engineering. With the Sentry IsoPure sampler, samples can be taken simply and safely from systems including vessels, tanks and pipelines. The IsoPure sampler was developed paying special attention to compact and true aseptic design. The result is minimal problems when mounting samplers in CIP or SIP applications, no need for consumables, and protection against process contamination.

### FEATURES

- Conformant to 3-A Sanitary Standards through third-party verification
- Valve body made from solid bar
- No dead space
- Resistant to aggressive fluids
- Hermetically sealed against the environment
- Long service life of PTFE bellows
- Drainable
- Bellows leakage indicator
- Maximize life cycles
- Ease of cleaning—CIP/SIP
- Folds of the PTFE bellows remain open for easy cleaning
- Modular system makes changing actuator more convenient
- Change seals without special tools
- Minimal downtimes
- Low spare parts or consumables cost
- PTFE bellows conforms to FDA regulations
- Wide variety of installation positions
- High quality product surface finishes available
- Optional electronic feedback



Conforms to 3-A Sanitary Standards  
through Third-Party Verification (TPV)



Sample. Monitor. Measure.  
**SENTRY**  
Any Application. Anywhere.

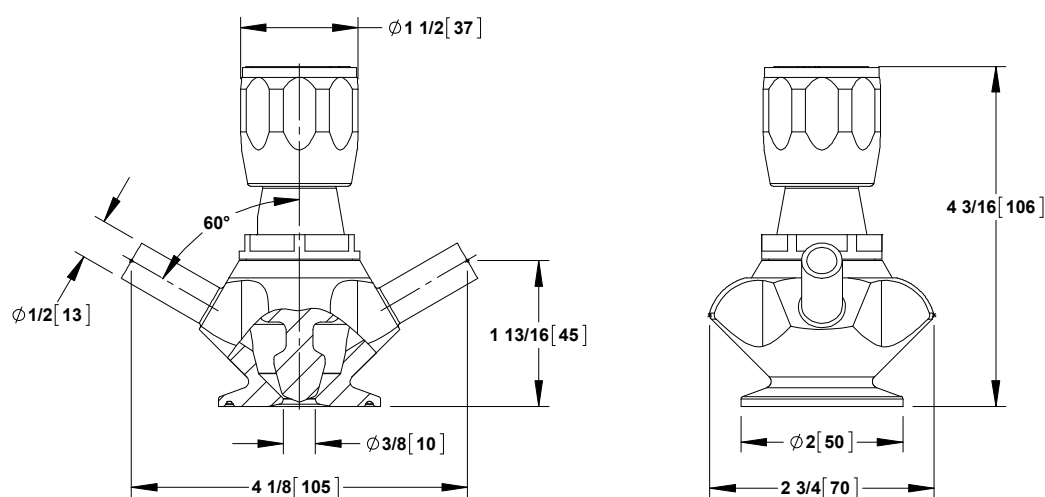

SPECIFICATIONS	
sizes	mounting: weld-end or 1-1/2 in tri-clamp sample port: 1/2 in weld-end, 1/2 in tri-clamp; others upon request
stroke	3 mm (0.118 in)
materials	product contact: AISI 316L
product contact seals	PTFE (FDA)
temperatures	for continuous operation: 250°F (121°C) for sterilization: 275°F (135°C)
pressure	operating pressure: max. 145 psi (10 bar) control air pressure: min. 87 psi (6 bar) to max. 145 psi (10 bar)
surface finish	product contact: Ra<= 32 µin (0.8 µm) not in contact with product: Ra<= 64 µin (1.6 µm)

[sentry-equip.com](http://sentry-equip.com)  
966 Blue Ribbon Circle North, Oconomowoc, WI 53066 U.S.A. | +1-262-567-7256 | [sales@sentry-equip.com](mailto:sales@sentry-equip.com)

© 2017 Sentry Equipment Corp. All rights reserved. Sentry is a registered trademark of Sentry Equipment Corp. It is solely the responsibility of end users, through their own testing and analysis, to select products and materials suitable for their specific application requirements, ensure they are properly installed, safely applied and properly maintained, and to limit their use to their intended purpose. Improper selection, installation or use may result in personal injury or property damage.  
S-LS-SPS-00503-0 3-17



COMPANY WITH  
QUALITY SYSTEM  
CERTIFIED BY DNV GL  
= ISO 9001 =