



*The  
Sampling  
Connection*

## MODEL A AUTOMATIC SAMPLER

### **Automatic Sampler for Free-Flowing Bulk Solid Materials**

#### **Features**

- Compact, easy to mount
- Low maintenance
- Product contact materials are 304 stainless steel
- Includes a sampler, air filter, regulator and air gauge

#### **Options**

- Custom mounting adapters
- Custom slide construction
- Custom construction materials
- Nickel-impregnated Teflon<sup>®</sup> for a non-stick surface
- Hardening treatments to protect against wear and abrasion



**MODEL A AUTOMATIC SAMPLER**

#### **Description**

The Model A sampler is designed for automatic sampling of free-flowing materials such as granules, coarse powders, flakes and pellets from screw or drag conveyors.

The Sentry Model A takes a sample when a solenoid-controlled air cylinder opens a sliding gate on the sampler, then closes the gate.

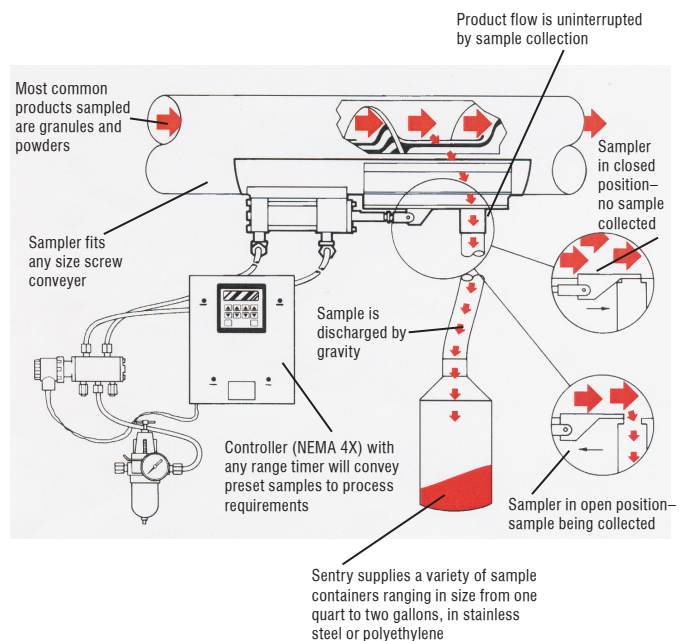

## MODEL A TECHNICAL DATA

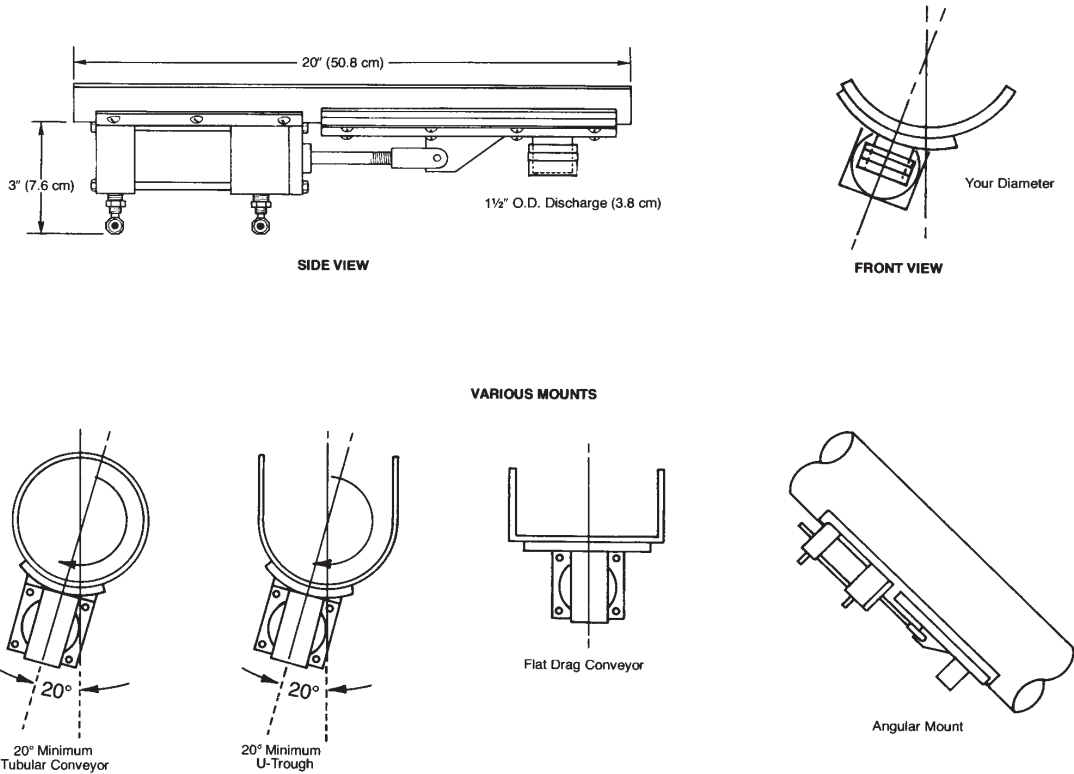

## SPECIFICATIONS

Basic Electrical Requirements for Control .....	115/230 VAC, single phase, 60 Hz; control box fused to 2 amps
Air Requirements .....	80 psig, 1.5 cfm per cycle
Quantity of Sample .....	determined by flow rate, aperture size and time in line
Product Size .....	10 micron to 1/4" / 6 mm; larger sizes upon request
Recommended Location of Sampler .....	screw conveyors or angled gravity chutes
Suggested Connection to Collection Point.....	rigid metal or flexible tubing to a collection container or multi-position collection cabinet
Materials of Construction .....	304 stainless steel; acetal spacers and urethane wiper seal
Temperature Range .....	up to 250°F / 121°C

### ⚠ WARNING

It is solely the responsibility of the end-user, through its own analysis and testing, to select products and materials suitable for their specific application requirements, ensure they are properly installed, safely applied, properly maintained, and limit their use to their intended purpose. Improper selection, installation, or use may result in personal injury or property damage.



### SENTRY EQUIPMENT CORP

PO Box 127  
Oconomowoc, WI 53066 USA  
Phone: 262-567-7256  
Fax: 262-567-4523

**E-mail:**  
sales@sentry-equip.com

**Website:**  
www.sentry-equip.com

For further information, contact:

**Rometec srl**

Via Alessandro Minuziano, 87 - 89

00128 - Roma

Tel 06-5061635 Fax 065061542

P.Iva 0412062100

**www.rometec.it**

*The Sampling Connection*