

SMU-1 Series

Inline Static Mixer

aerospace
 climate control
 electromechanical
 filtration
 fluid & gas handling
 hydraulics
 pneumatics
 process control
 sealing & shielding

Product Overview:

The SMU-1 Series is designed for semiconductor fluid, ultra-pure water and aggressive chemical applications; and slurry media.

The patent pending SMU-1 Series includes innovative mixing technology designed for improved blending techniques. They are available in 1/4", 3/8", 1/2", 3/4", and 1" port sizes.

In addition, the static mixers can be integrated directly into custom manifolds. The custom manifolding offers compact, point of use blending and mixing applications; allowing for less dead volume areas and gives the most efficient internal flow paths for mixing.



Contact Information:

Parker Hannifin Corporation
Veriflo Division
Partek Operation
7075 East Southpoint Road
Tucson, Arizona 85756

phone 520 574 2600
fax 520 574 2700

www.parker.com/partek

Product Features:

- Compact overall sizes as compared to 12" and 18" competitive mixing technologies.
- Smaller footprint offers space saving for OEM systems and compact areas in facilities.
- Improved radial mixing efficiency and consistency allows quick and convenient mixing of chemicals, CMP slurry, and de-ionized water.
- 100% ultra-high purity PTFE materials of construction provides a pure and inert material that is chemically resistant.
- No moving parts yields less modes of failure and extends product life.



ENGINEERING YOUR SUCCESS.

SMU-1 Series

Dimensional Drawing

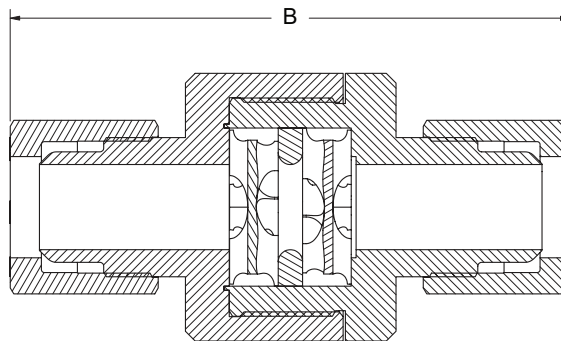
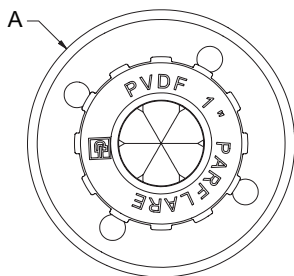

Ordering Information

Model Number	End Size	End Type	Cv	A		B	
				inch	mm	inch	mm
SMU-1-6644	1/4"	PARFLARE	.10	Ø1.25	Ø31.75	3.84	97.54
SMU-1-6666	3/8"		.72	Ø1.25	Ø31.75	4.00	101.60
SMU-1-6688	1/2"		1.43	Ø1.50	Ø38.10	4.16	105.66
SMU-1-661212	3/4"		2.01	Ø1.86	Ø47.24	4.34	110.24
SMU-1-661616	1"		4.09	Ø2.75	Ø69.85	5.76	146.30

Parflare models are supplied with PVDF nuts. For PFA nuts add -T to model number. Contact factory for Pillar end connections.

Manifold Capable: Engineered manifolds up to 5:1 (inlet:outlet) with integrated check valves and shut off valves are available with inline static mixers. Contact factory for quote.

Specifications

Materials of Construction		Temperature Ranges	
Wetted Options	PTFE	Ambient	1/4" & 3/8" End Size: 32° - 212° F (0° - 100° C)
Non-wetted Options	PTFE, PVDF or PFA Nut Material		1/2" & 3/4" End Size: 50° - 212° F (10° - 100° C)
			1" End Size: 60° - 212° F (15° - 100° C)
Pressure Ranges		Fluid	1/4" & 3/8" End Size: 32° - 266° F (0° - 130° C)
Ranges	27" Hg vacuum (913 mbar - 120 PSIG (8.3 bar))		1/2" & 3/4" End Size: 50° - 266° F (10° - 130° C)
			1" End Size: 60° - 266° F (15° - 130° C)

Pressure ranges for operation at ambient temperatures. For additional information on materials of construction, functional performance and operating conditions, please contact factory.

OFFER OF SALE:

The items described in this document are hereby offered for sale by Parker-Hannifin Corporation, its subsidiaries or its authorized distributors. This offer and its acceptance are governed by the provisions stated in the detailed "Offer of Sale" elsewhere in this document or available at www.parker.com/veriflo



FAILURE OR IMPROPER SELECTION OR IMPROPER USE OF THE PRODUCTS DESCRIBED HEREIN OR RELATED ITEMS CAN CAUSE DEATH, PERSONAL INJURY AND PROPERTY DAMAGE. THIS DOCUMENT IS FOR REFERENCE ONLY. PLEASE CONSULT FACTORY FOR LATEST PRODUCT DRAWINGS AND SPECIFICATIONS

This document and other information from Parker-Hannifin Corporation, its subsidiaries and authorized distributors provide product or system options for further investigation by users having technical expertise.

The user, through its own analysis and testing, is solely responsible for making the final selection of the system and components and assuring that all performance, endurance, maintenance, safety and warning requirements of the application are met. The user must analyze all aspects of the application, follow applicable industry standards, and follow the information concerning the product in the current product catalog and in any other materials provided from Parker or its subsidiaries or authorized distributors.

To the extent that Parker or its subsidiaries or authorized distributors provide component or system options based upon data or specifications provided by the user, the user is responsible for determining that such data and specifications are suitable and sufficient for all applications and reasonably foreseeable uses of the components or systems.



ENGINEERING YOUR SUCCESS.