

防混阀.MIXING PROOF VALVE

外清洗双座防混阀在开关过程中阀瓣的位置

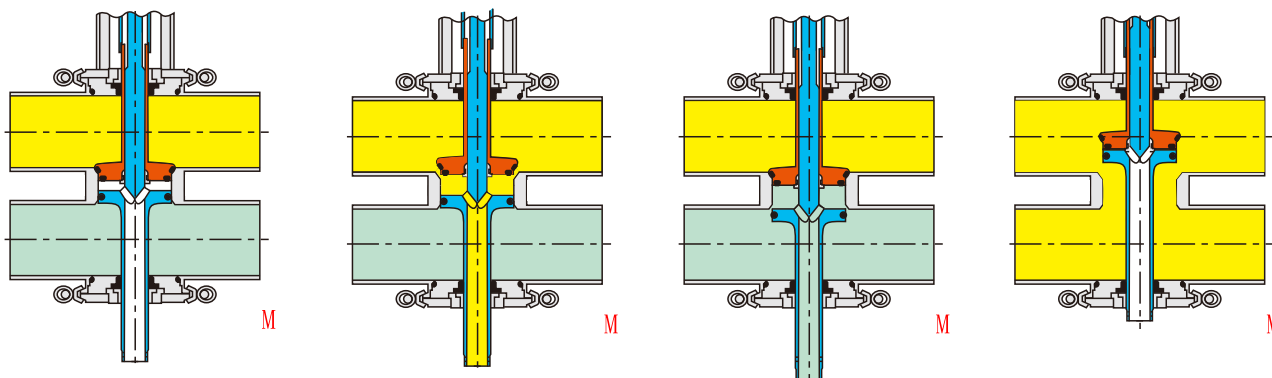

阀门关闭时，上下阀腔各自由单独的阀座密封。中间泄露通道可通过外部进行单独CIP清洗。

When the valve is closed, up and down the valve Cavities each with a separate seat seal. Middle leak channel, It can be done separately from the outside CIP cleaning.

阀门开启时，上阀座向上提升，上阀体内的液体可从泄露通道中流出。下阀座由单独阀座密封。

Valve open, the valve seat Lift up on the valve body The liquid can leak from the channel In the outflow. Lower seat by a single Single seat seal.

阀门开启时，下阀座向下提升，上阀体内的液体可从泄露通道中流出。上阀座由单独阀座密封。

When the valve is open, the lower seat Lift down on the valve body The liquid can leak from the channel In the outflow. Seat on the single Single seat seal.

阀门开启，下阀座提升，下阀座提升时和上阀座间的隔离腔关闭，使得阀门开启时泄露通道无泄露。

Valve open, under the seat to mention L, under the seat to enhance and Upper chamber between the isolation chamber off Close, making the valve open No leakage of leaks.

防混阀可以组合成防混阀阵，凭借防混阀阵可以实现安全、高效、卫生的物料输送操作；这在需要频繁切换物流通道，安全性，卫生性要求高的场合有较好的应用。

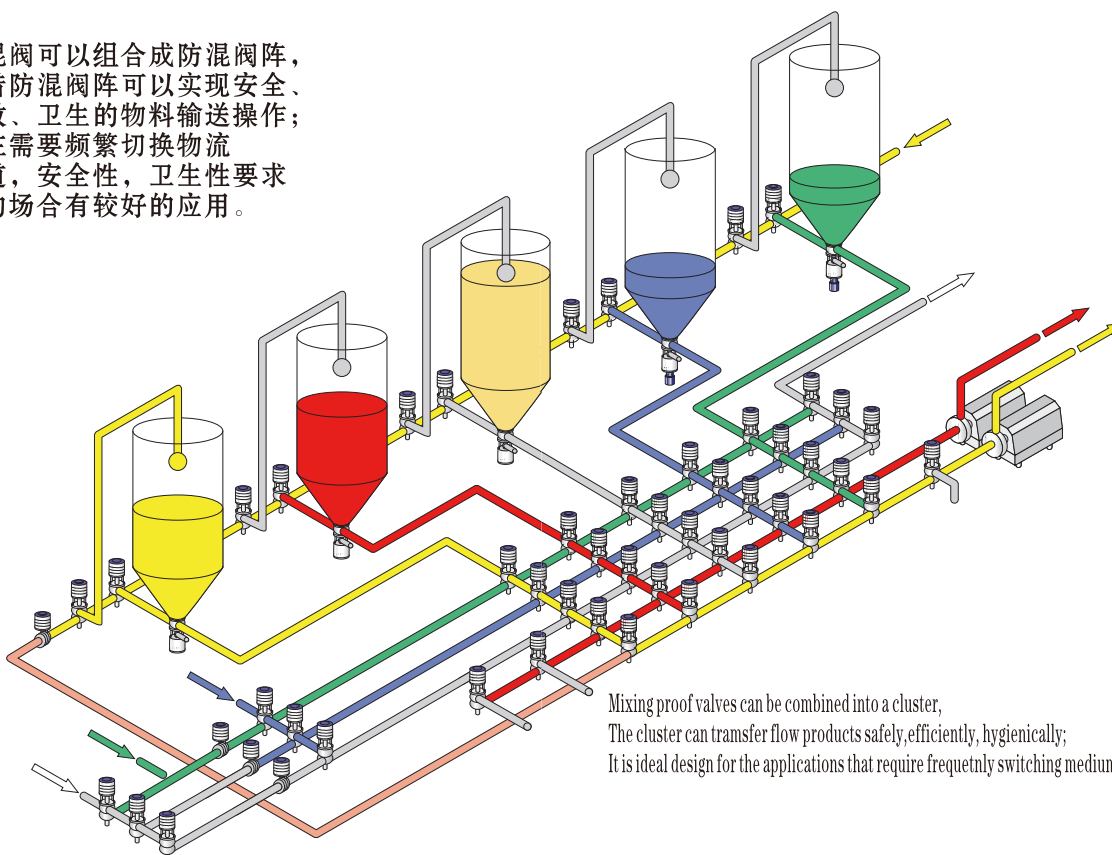

Mixing proof valves can be combined into a cluster, The cluster can transfer flow products safely, efficiently, hygienically; It is ideal design for the applications that require frequently switching medium.

防混阀.MIXING PROOF VALVE

F01 Series Mix Proof Valve Characteristics

This valve is used to proof the mix of different material in the pipeline cross. While the valve is close, the two pipes are double sealed, the liquid leaking from one pipe to the other can be eliminated. While the seal is damaged, the leakages will be drained by the draining chamber. The supplier of lotion to the isolation chamber is connected by a unique CIP and also the isolation chamber cleaning is indifferent to the valve position.

F02 Series Double Seals Mix Proof Valve Characteristics

This Valve is used as the mix proof separation in the pipe system by adopting one valve disc with two seals tech. This valve is the economic choice among the double seat valve. The chamber between the valve disc seals is connected with two drain valves, by which we can detect the seal leakage and clean the chamber.



The Advantages Compared With Traditional Design

- Less components
- Less space
- Easier maintenance
- No dead corner
- No contact between drain system and products
- The separation chamber cleaning will not occur any hydraulic-pressure and not influenced by the equipment or valve status.

Technical Parameter

Material Press Range: 0~8bar

Operative Temp. Range: -10°C~+150°C

Operative Air Press: 6~8bar

Material

Material Contact Parts: 304 or 316L

Sealing material: standard EPDM Silicone, FPM for option

Surface Treatment

Outside: Sandblast $Ra \leq 1.6 \mu m$

Sublight $Ra \leq 0.6 \mu m$

Inside: polish $Ra \leq 0.6 \mu m$

Requirements For Compressed Air Quality That The Executor Needs

Compressed air joint: air pipe equipped with air adapter R1/8"

Max grain size: $0.01 \mu m$

Max oil content: 0.08ppm

Dew point: below 10°C or less

Max water content: 7.5g/kg

防混閥.MIXING PROOF VALVE

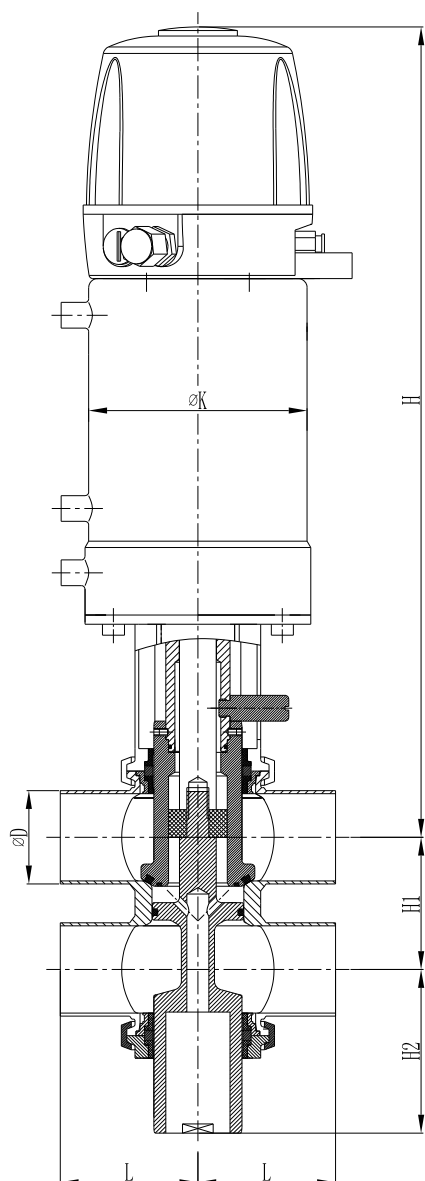

Part no:MXV01

Size	D	H2	H1	L	K	H
1 1/2"	38.1×1.5	90	60	65	83	442
2"	50.8×1.5	100	72	85	123	468
2 1/2"	63.5×2.0	110	86.8	100	123	474
3"	76.2×2.0	135	102.9	125	173	632
4"	101.6×2.0	150	127.6	150	173	632

Part no:MXV02

Size	D	H2	H1	L	K	H
DN40	40×1.5	90	63.2	65	83	443
DN50	52×1.5	100	74.5	85	123	469
DN65	70×2.0	115	92	100	123	477
DN80	85×2.0	140	111	125	173	624
DN100	104×2.0	150	130	150	173	633

閥体组合 Body combination

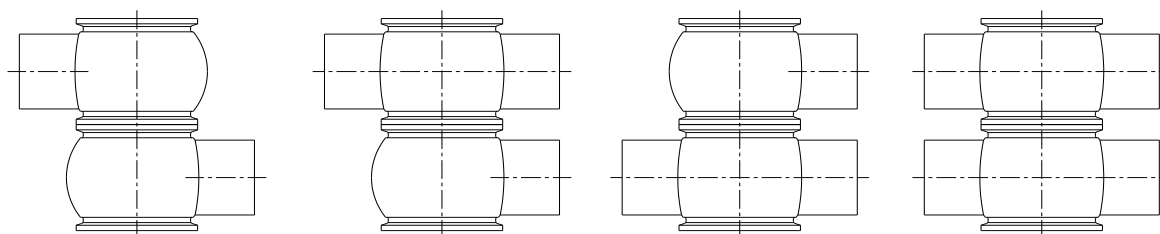

11

12

21

22

防混阀.MIXING PROOF VALVE

外清洗单座双密封防混阀

CIP mixing proof valve, single seat double sealing



外清洗单座双密封防混阀在开关过程中阀瓣的位置

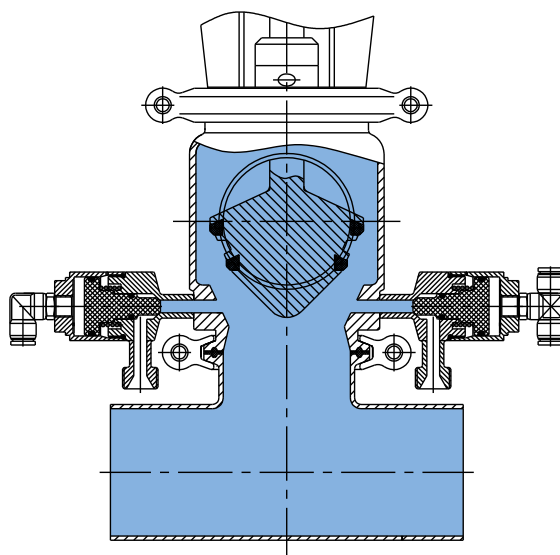
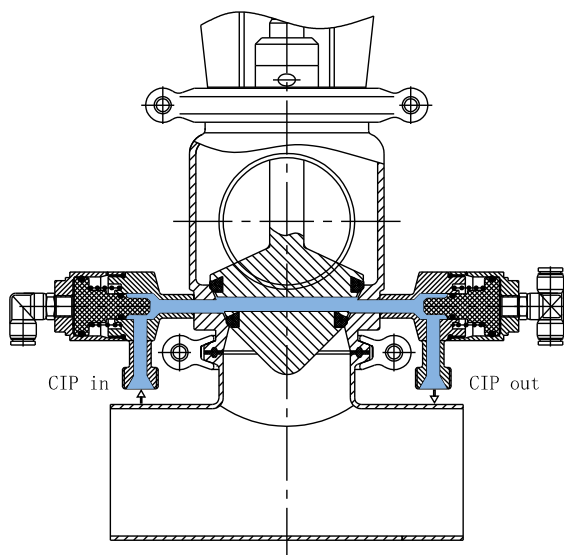

防混閥.MIXING PROOF VALVE

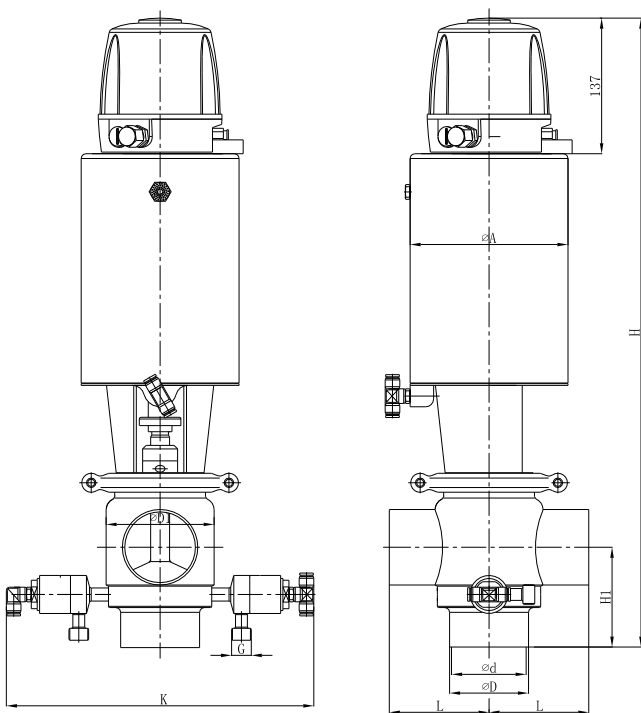

Part no:MXV03

size	d	D	A	H1	L	K	G	D1	H
1.5"	35.1	38.1	86	69	69	260	3/8"	79	488
2.0"	47.8	50.8	86	72	72	260	3/8"	79	485
2.5"	59.5	63.5	133	82	82	269	3/8"	93	550

Part no:MXV04

size	d	D	A	H1	L	K	G	D1	H
DN40	35.1	38.1	86	69	69	260	3/8"	79	488
DN50	47.8	50.8	86	72	72	260	3/8"	79	485

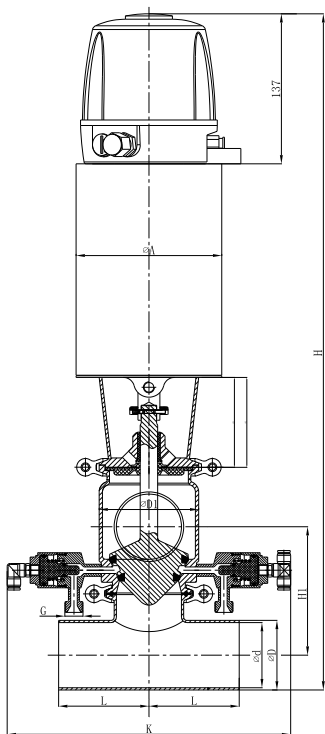

Part no:MXV05

size	d	D	A	H1	L	K	G	D1	H
1.5"	35.1	38.1	86	97	68.5	260	3/8"	79	539
2.0"	47.8	50.8	86	102	72	260	3/8"	79	547
2.5"	59.5	63.5	133	117	82.5	269	3/8"	93	618

Part no:MXV06

size	d	D	A	H1	L	K	G	D1	H
DN40	35.1	38.1	86	97	68.5	260	3/8"	79	539
DN50	47.8	50.8	86	102	72	260	3/8"	79	547