

Rigid Grooved Coupling

1G

Rigid Coupling

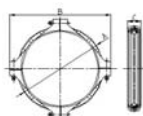
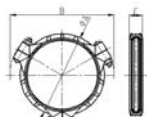
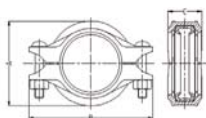

Nominal Size mm/in	Pipe D mm/in	Working Pressure PSI/MPa	Dimensions			Bolt Size No.-Size mm	Certificate
			A mm/in	B mm/in	C mm/in		
25	33.7	500	59	100	44	3/8X55-2	UL FM
1	1.327	3.45	2.33	3.94	1.74	3/8X55-2	VdS LPCB
32	42.4	500	66	105	45	3/8X55-2	UL FM
1 1/4	1.669	3.45	2.60	4.13	1.78	3/8X55-2	VdS LPCB
40	48.3	500	72	112	45	3/8X55-2	UL FM
1 1/2	1.900	3.45	2.84	4.41	1.78	3/8X55-2	VdS LPCB
50	60.3	500	85	130	45	3/8X55-2	UL FM
2	2.375	3.45	3.35	5.12	1.78	3/8X55-2	VdS LPCB
65	73.0	500	98	140	45	3/8X55-2	UL FM
2 1/2	2.875	3.45	3.86	5.52	1.78	3/8X55-2	LPCB
65	76.1	500	101	145	45	3/8X55-2	UL FM
2 1/2	3.000	3.45	3.98	5.71	1.77	3/8X55-2	VdS LPCB
80	88.9	500	115.0	168	46	1/2X70-2	UL FM
3	3.500	3.45	4.53	6.62	1.82	1/2X70-2	VdS LPCB
100	108.0	500	140	197	52	1/2X70-2	UL FM
4	4.250	3.45	5.51	7.76	2.05	1/2X70-2	LPCB
100	114.3	500	146	200	52	1/2X70-2	UL FM
4	4.500	3.45	5.75	7.88	2.05	1/2X70-2	VdS LPCB
125	133	450	165	226	52	5/8X85-2	UL FM
5	5.250	3.10	6.50	8.90	2.05	5/8X85-2	LPCB
125	139.7	450	170	235	52	5/8X85-2	UL FM
5	5.500	3.10	6.69	9.25	2.05	5/8X85-2	VdS LPCB
125	141.3	450	172	235	52	5/8X85-2	UL FM
5	5.563	3.10	6.77	9.25	2.05	5/8X85-2	LPCB
150	159.0	450	190	267	52	5/8X85-2	UL FM
6	6.250	3.10	7.48	10.51	2.05	5/8X85-2	LPCB
150	165.1	450	198	262	52	5/8X85-2	UL FM
6	6.500	3.10	7.80	10.32	2.05	5/8X85-2	LPCB
150	168.3	450	202.0	265	52	5/8X85-2	UL FM
6	6.625	3.10	7.95	10.43	2.05	5/8X85-2	VdS LPCB
200	219.1	450	260.0	342	62	3/4X115-2	UL FM
8	8.625	3.10	10.24	13.45	2.44	3/4X115-2	VdS LPCB
250A	267.4	300	318	396	63	3/4X120-2	UL FM
10	10.528	2.07	12.52	15.60	2.48	3/4X120-2	UL FM
250	273.0	300	327	420	63	7/8X125-2	UL FM
10	10.750	2.07	12.88	16.54	2.48	7/8X125-2	LPCB
300A	318.5	300	364	456	63	7/8X140-2	UL FM
12	12.539	2.07	14.33	17.95	2.48	7/8X140-2	UL FM
300	323.9	300	370	465	63	7/8X140-2	UL FM
12	12.750	2.07	14.57	18.30	2.48	7/8X140-2	UL FM
350	355.6	300	415	510	72	7/8X140-3	UL FM
14	14.000	2.07	16.34	20.08	2.84	7/8X140-3	UL FM
350	377.0	225	435	535	72	7/8X140-3	FM
14	14.842	1.6	17.13	21.05	2.84	7/8X140-3	UL FM
400	406.4	300	468	575	72	7/8X140-3	UL FM
16	16.000	2.07	18.43	22.64	2.84	7/8X140-3	UL FM
400	426.0	225	490	592	72	7/8X140-4	FM
16	16.772	1.6	19.29	23.30	2.84	7/8X140-4	UL FM
500	529.0	225	595	700	76	7/8X140-4	UL FM
20	20.827	1.6	23.43	27.56	3.00	7/8X140-4	UL FM

1GS

Light-duty Rigid Coupling

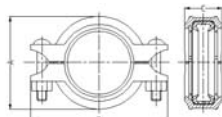

Nominal Size mm/in	Pipe D mm/in	Working Pressure PSI/MPa	Dimensions			Bolt Size No.-Size mm	Certificate
			A mm/in	B mm/in	C mm/in		
65	76.1	300	100	140	45	3/8X55-2	UL FM
2 1/2	3.000	2.07	3.94	5.52	1.77	3/8X55-2	UL FM
80	88.9	300	114	160	45	3/8X55-2	UL FM
3	3.500	2.07	4.50	6.30	1.78	3/8X55-2	UL FM
100	108.0	300	135	185	50	1/2X70-2	UL FM
4	4.250	2.07	5.30	7.28	1.97	1/2X70-2	UL FM
100	114.3	300	140	187	50	1/2X70-2	UL FM
4	4.500	2.07	5.51	7.36	1.97	1/2X70-2	UL FM
125	139.7	300	168	225	50	1/2X75-2	UL FM
5	5.500	2.07	6.62	8.86	1.97	1/2X75-2	UL FM
125	141.3	300	170	225	50	1/2X75-2	UL FM
5	5.563	2.07	6.69	8.86	1.97	1/2X75-2	UL FM
150	159.0	300	190	252	50	5/8X80-2	UL FM
6	6.250	2.07	7.48	9.92	1.97	5/8X80-2	UL FM
150	165.1	300	195	250	50	1/2X75-2	UL FM
6	6.500	2.07	7.68	9.84	1.97	1/2X75-2	UL FM
150	168.3	300	200	255	50	1/2X75-2	UL FM
6	6.625	2.07	7.87	10.04	1.97	1/2X75-2	UL FM
200A	216.3	300	255	320	58	5/8X85-2	UL FM
8	8.516	2.07	10.04	12.60	2.28	5/8X85-2	UL FM
200	219.1	300	255	322	58	5/8X85-2	UL FM
8	8.625	2.07	10.05	12.68	2.28	5/8X85-2	UL FM
250	273.0	300	318	410	63	3/4X120-2	UL FM
10	10.750	2.07	12.52	16.14	2.48	3/4X120-2	UL FM



Ref: 566

Rapidrop Global