

Flexible Grooved Coupling

1N

Flexible Coupling

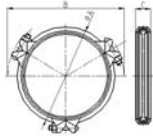
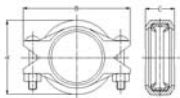

Nominal Size mm/in	Pipe O.D mm/in	Working Pressure PSI/MPa	Dimensions			Bolt Size No.-Size mm	Certificate
			A mm/in	B mm/in	C mm/in		
25 1	33.7 1.327	500 3.45	55 2.16	92 3.62	42 1.65	3/8X55-2	UL FM VdS LPCB
32 1¼	42.4 1.669	500 3.45	65 2.56	104 4.14	44 1.74	3/8X55-2	UL FM VdS LPCB
40 1½	48.3 1.900	500 3.45	70 2.75	110 4.33	44 1.74	3/8X55-2	UL FM VdS LPCB
50 2	60.3 2.375	500 3.45	83 3.27	124 4.88	44 1.74	3/8X55-2	UL FM VdS LPCB
65 2½	73.0 2.875	500 3.45	96 3.78	143 5.63	45 1.78	3/8X55-2	UL FM LPCB
65 2½	76.1 3.000	500 3.45	100 3.94	145 5.71	45 1.78	3/8X55-2	UL FM VdS LPCB
80 3	88.9 3.500	500 3.45	115 4.53	160 6.30	45 1.78	1/2X70-2	UL FM VdS LPCB
100 4	108.0 4.250	500 3.45	138 5.43	190 7.48	50 1.97	1/2X70-2	UL FM LPCB
100 4	114.3 4.500	500 3.45	145 5.71	198 7.80	50 1.97	1/2X70-2	UL FM VdS LPCB
125 5	133 5.250	450 3.10	162 6.38	225 8.86	51.0 2.01	5/8X80-2	UL FM LPCB
125 5	139.7 5.500	450 3.10	169 6.65	230 9.06	52 2.05	5/8X80-2	UL FM VdS LPCB
125 5	141.3 5.563	450 3.10	170 6.69	232 9.13	51 2.01	5/8X80-2	UL FM LPCB
150 6	159.0 6.250	450 3.10	190 7.48	254 10.00	52 2.05	5/8X85-2	UL FM LPCB
150 6	165.1 6.500	450 3.10	196 7.72	260 10.24	52 2.05	5/8X85-2	UL FM LPCB
150 6	168.3 6.625	450 3.10	200 7.87	265 10.43	52 2.05	5/8X85-2	UL FM VdS LPCB
200 8	219.1 8.625	450 3.10	258 10.24	350 13.78	60 2.37	3/4X115-2	UL FM VdS LPCB
250 10	273.0 10.750	300 2.07	337 13.27	406 16.00	65 2.56	7/8X140-2	UL FM VdS
300 12	323.9 12.750	300 2.07	372 14.65	460 18.11	64 2.52	7/8X140-2	UL FM
350 14	377.0 14.842	225 1.6	428 16.85	520 20.45	72 2.85	7/8X140-3	UL FM
400 16	426.0 16.772	225 1.6	476 18.74	570 22.45	73 2.87	7/8X140-3	UL FM

1NS

Light-duty Flexible Coupling

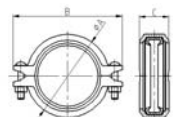

Nominal Size mm/in	Pipe O.D mm/in	Working Pressure PSI/MPa	Dimensions			Bolt Size No.-Size mm	Certificate
			A mm/in	B mm/in	C mm/in		
125 5	139.7 5.500	450 3.10	168 6.61	228 8.98	51 2.01	5/8X80-2	UL FM
165 6	168.3 6.625	450 3.10	200 7.87	265 10.43	52 2.05	5/8X85-2	UL FM
250 10	273.0 10.750	300 2.07	320 12.60	395.0 15.55	64 2.52	3/4X120-2	UL FM



Ref: 566

Rapidrop Global