

Flexible Sprinkler Connections

Models SPB, SPNB & SPWB (See Fig 1 Overleaf)

Installation Instructions

FM Issue 1 Page 1 of 2
1 Oct 2006
FM Approved

- 1) Install the Inlet Nipple (1" pipe thread end) in the range pipe outlet using the normal sealing and tightening methods for connecting pipe threads for leak proof joints. NB. For SPWB this nipple is permanently fixed to the flexible hose and care must be taken not to twist the hose or use it as a lever when tightening in the nipple.
- 2) For SPB only - Check the '□' Packing is in place flush against the shoulder on one end of the flexible and connect the Reducer (M33 x 1.5 thread end) to that end and tighten the nut. NB. For SPNB and SPWB the reducer is permanently fixed to the flexible hose.
- 3) For SPB and SPNB - Check that the '□' Packing is in place flush against the shoulder on the other end of the flexible and connect that end to the open end of the inlet nipple on the range pipe and tighten the nut. NB. For SPWB this step does not apply.
- 4) Bend the flexible by hand (Min. Bend Radius 140mm – See Fig. 2) to take up the desired route for the flexible and position the reducer for the sprinkler location. (eg. Centre of Tile)
When bending leave 60mm straight (no bend) from the end fitting, ensure there are no kinks or bends tighter than the minimum bend radius.

For FM installations the FM guidelines for the installation of all flexibles must be followed.

- 5) The reducer (Outlet) must be located securely to prevent movement relative to the ceiling resulting from the system being pressurized, from sprinkler operation and from discharge of water if the sprinkler operates as the result of a fire. The fixing must also resist torsional forces which result from a sprinkler being installed in the reducer.

The Rapidrop[®] Reducer is easily located centre of tile in 1,200mm x 600mm (See Fig.4) and 600mm x 600mm tiles (See Fig.5) but must be fixed to the 1,200mm long Cross Tees of the ceiling suspension system using the Rapidrop[®] support bar and brackets supplied. (NB. Rapidrop[®] must not be bracketed to reduced height or lightweight cross tees.)

If there are no available, suitable 1,200mm long cross tees, Rapidrop[®] must be fixed to the Main Runners of the ceiling suspension system. As the Main Runners are spaced at 1,200mm this method requires a longer support bar which is available. (See Fig. 6). Do not overtighten the bracket screws.

Rapidrops[®] less than 1.6 metre long do not require any intermediate support between the range pipe connection and the brackets to the ceiling suspension system. Rapidrops[®] longer than 1,6m up to 2.54m long must have one intermediate support direct from the building structure. This support must be located not more than 1.6m (measured along the route of the flexible) from the sprinkler connection. As the Rapidrop[®] flexible is stainless steel, insulation between the support hanger and the corrugated flexible must be provided to prevent direct metal to metal contact.

- 6) Install the sprinkler and pressure test in the normal way. Max. Working Pressure 175Psi (12 bar.) After filling with water for pressure test please keep the sprinkler system always filled with water. Do not leave the system drained for long periods.



Flexible Sprinkler Connections

Models SPB, SPNB & SPWB

Installation Instructions

FM Issue 1 Page 2 of 2

1 Oct 2006

FM Approved

Figure 1

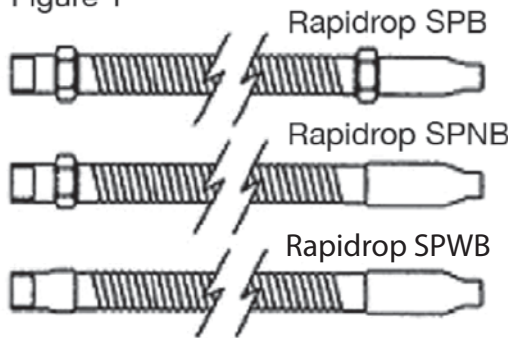

Figure 2

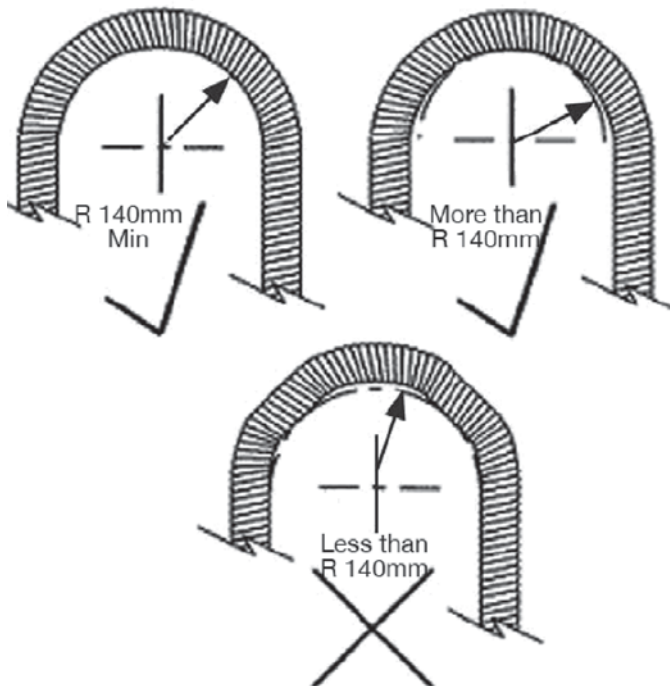

Figure 3

Bracket B 4 - 1E

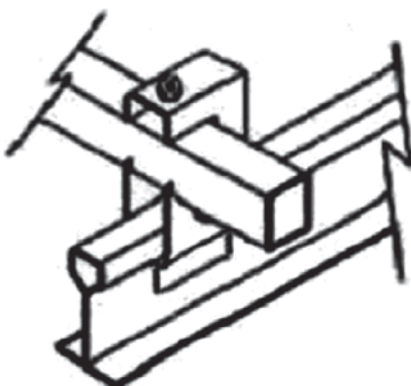

Figure 4

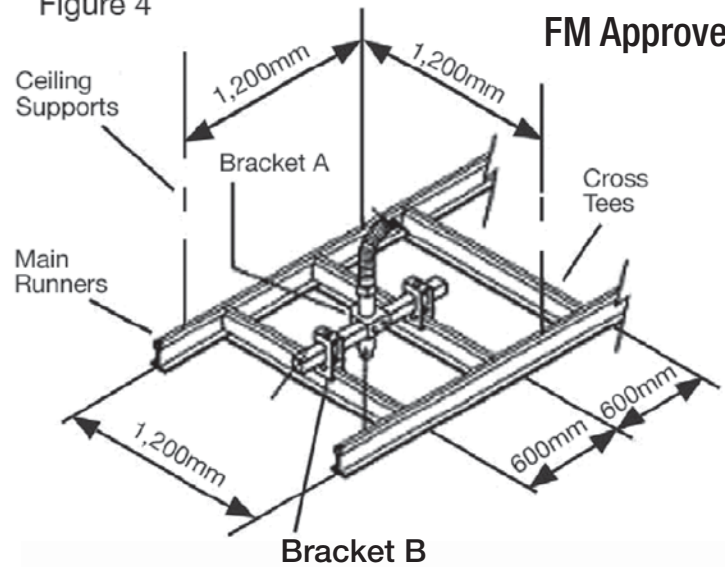

Figure 5

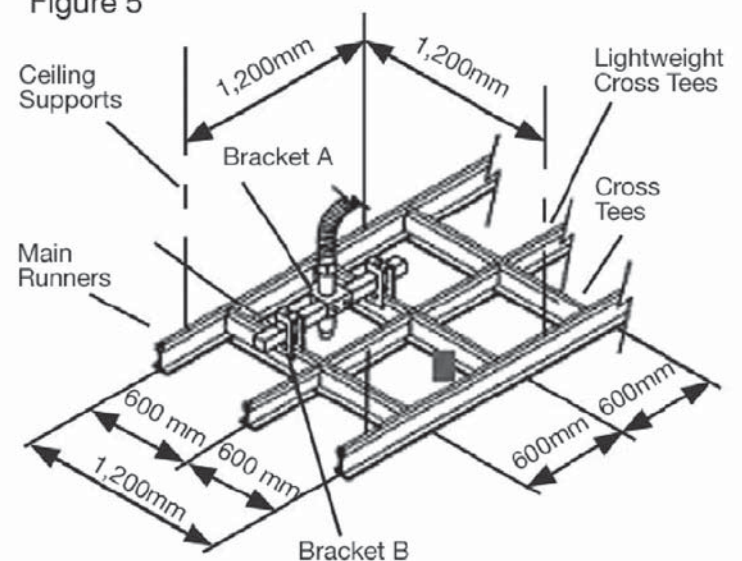
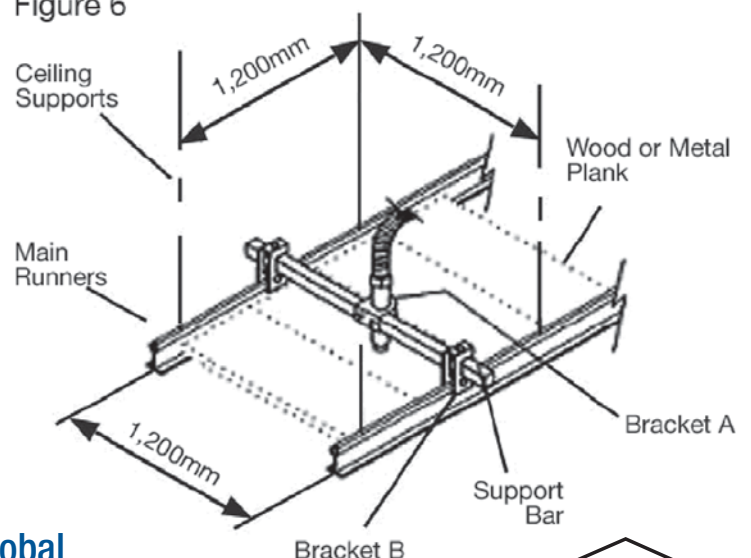

Figure 6



Rapidrop Global

